

Ron Cooke Hub and Heslington East Directions

Please note access to both Kimberlow Lane and Field Lane car parks can only be reached via the Grimston Bar Park and Ride junction and CANNOT be accessed via Field Lane.

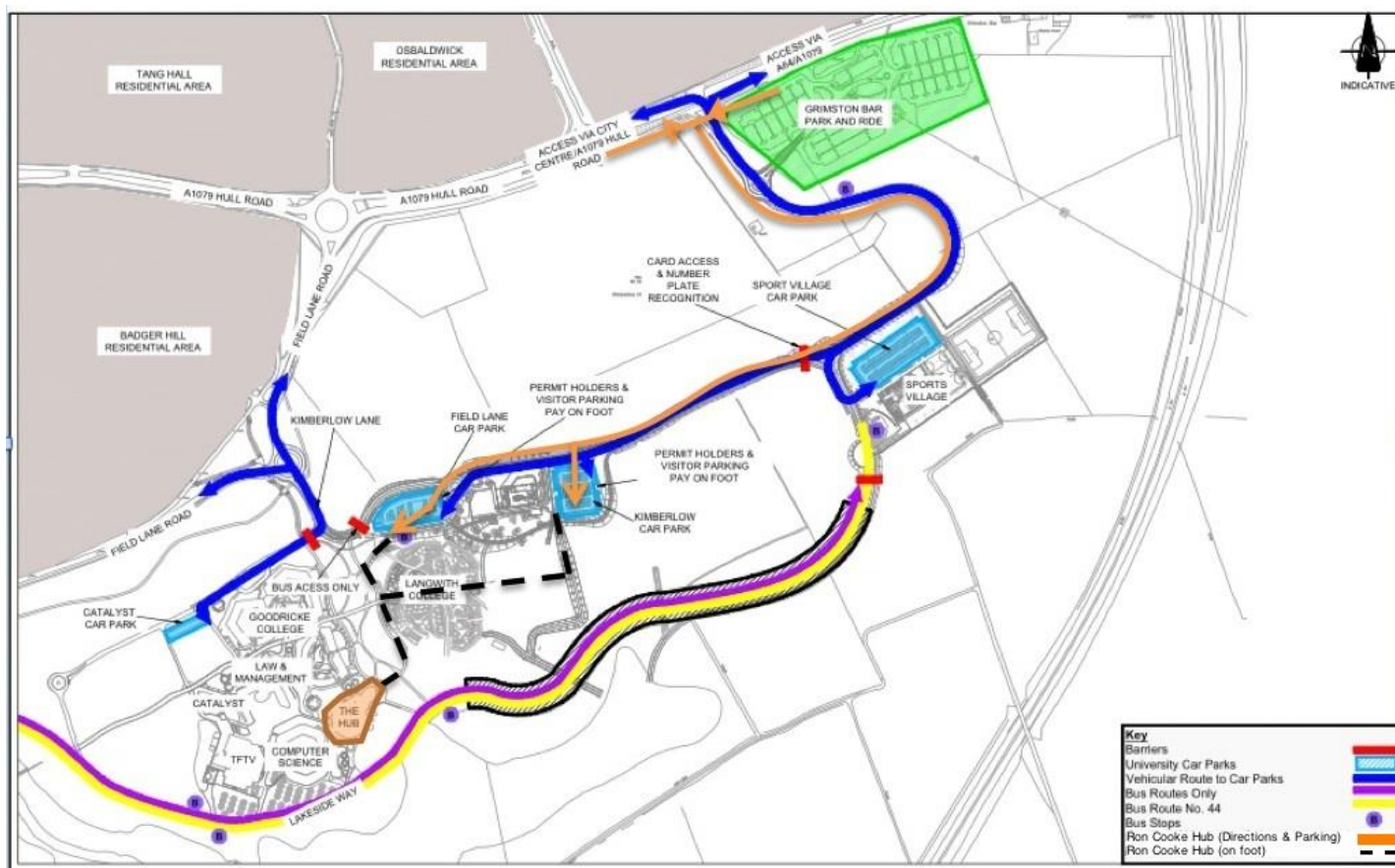

Directions from the A64

Follow the outer ring road (A64 S&E or A1237 N&W) to the Hull/Bridlington (A1079/A166) roundabout. At the roundabout follow the road to York and take the first exit towards Grimston Bar Park and Ride, at the small roundabout go straight ahead until reaching the barriers at the second roundabout. Tickets can be taken from this barrier and follow the road to either Kimberlow Lane or Field Lane car park.

Directions from York

Follow the signs to Hull A1079 and Bridlington A166 until reaching Hull Road, continue to drive along Hull Road towards the A64 Take the right hand turning towards Grimston Bar Park and Ride and the Sports Village at the small roundabout go straight ahead until reaching the barriers at the second roundabout. Tickets can be taken from this barrier and follow the road to either Kimberlow Lane or Field Lane car park.

Bus

There are frequent buses between the city centre and Heslington East via the number 44. The number 44 is also free when commuting between the Heslington West main campus and Heslington East.

SatNav

Use postcode YO19 5LA to be directed to the Grimston Bar Park and Ride junction.

Parking

Parking is available at Field Lane and Kimberlow Lane car parks which are only accessible via the Grimston Bar Park and Ride junction. A barrier system is in place at the roundabout leading to the car parks. Please take a ticket at this barrier and make payment at the payment machines in the car park when exiting. Short stay parking for up to 45 minutes is free, longer stays are charged at £1 per hour and is free from 6pm – 8am and on weekends.